

# SAFT



## Resilient power with Go Electric's Lync™ Hub solution

The all-in-one building microgrid. Portable, flexible, comprehensive.

Resilience is now readily available in a single deliverable system that is flexible, cost effective and quickly deployed.

Go Electric has developed Lync™ Hub (Portable microgrid all-in-one), a compact and quickly installed microgrid that can be customized for your needs.

### Lync™ Hub Solution

Control and optimize multiple decentralized energy assets

Interface with main grid or quickly island when necessary

Manage peak shaving and power factor corrections

Product range as 75 kW to 500 kW with 1 to 4 hours of autonomy

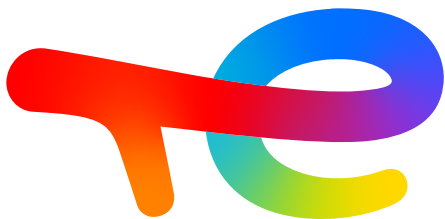

**TotalEnergies**



## Lync™ Hub 75 - 500 kW installation

- Uninterruptible power, energy storage, microgrid controls, with embedded peak shaving, load shifting and demand response functionalities
- Prime generation option: solar power
- Fully integrated and pre-commissioned
- 40', 30' and 20' ISO container footprint
- Pad, pillar or trailer mountable
- Open protocol communications

## Lync™ Hub enables customers to monetize resiliency within a comprehensive offering

- Rate based design that supports grid
- Properly values customer owned solar production
- Allows for demand response
- SCADA compatible to interface in a controls hierarchy
- Multiple configurations available from 75 to 500 kW to support various use cases

## Benefits at a glance

### Quantifiable Resilience

- ▶ Your customers remain operational and continue utilizing PV when the grid is down

### Meet Peak Demand

- ▶ Automated peak shaving and load shifting reduce system-wide demand

### Increase Demand Response

- ▶ Customers easily enroll in demand response programs without cost burden and impact on operations

### Useful Renewables

- ▶ Solar energy now contributes to resiliency, peak management and energy efficiency, rather than de-optimizing grid operation through net-metering schemes

### Flexible Deployment

- ▶ Lync™ Hub is designed on standard ISO containers and can be deployed as pad mounted or trailer mounted based on customer needs

### Pre-integrated package

- ▶ Reduce costs associated to design, construction and field commissioning

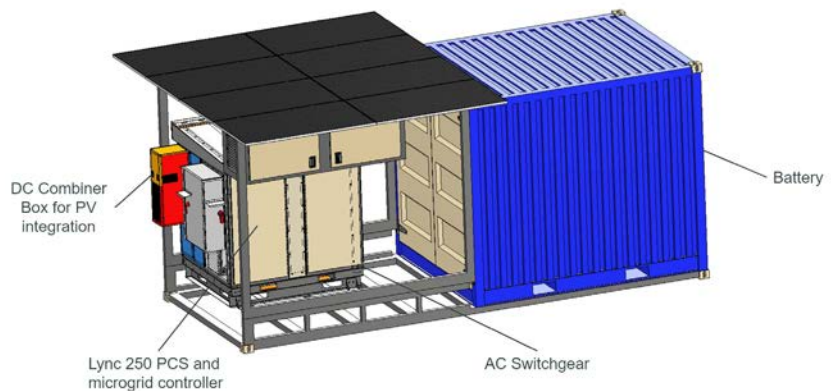

## Saft

26 quai Charles Pasqua  
92300 Levallois-Perret - France  
Tel: +33 1 58 63 16 00  
Fax: +33 1 58 63 16 18  
[www.saftbatteries.com](http://www.saftbatteries.com)

## Go Electric

1920 Purdue Parkway  
Suite 400  
Anderson, Indiana - USA  
Tel.: 765-400-1347  
[www.goelectricinc.com](http://www.goelectricinc.com)